

The Estate Agent People Recommend



101 Fairwater Drive,
Woodley
RG5 3JQ

£339,995



Wentworth Estate Agents have pleasure in offering to the market a THREE BEDROOM MID TERRACE HOUSE located in the Southlake development of Woodley.

Within 0.8 miles is Woodley Town Centre with local shops, pubs, banks, restaurants, and Waitrose. The popular Waterside Bar and Restaurant is within walking distance to the property.

For the commuter this property gives very easy access to the A4, A329M, M4 and A329 and Reading can be reached by a regular bus service. Rail links are Earley to Waterloo, Reading and Twyford to Paddington.

Catchment for Southlake Primary School, Highwood Primary School and Bulmershe Senior School.

Ground Floor accommodation comprises of entrance Hall, Living Room/Dining Room with sliding doors into the garden, kitchen with plenty of eye and base level units, 4 ring gas hob, oven and door leading into the garden.

First floor accommodation comprises of master bedroom at the front of the property, further two bedrooms and newly refurbished fully tiled bathroom with bath and shower over, WC and wash hand basin.

Further Benefits include Gas central heating, UPVC Double glazing, Garage in block, parking, private laid to lawn garden with patio area and shed.

EPC - D

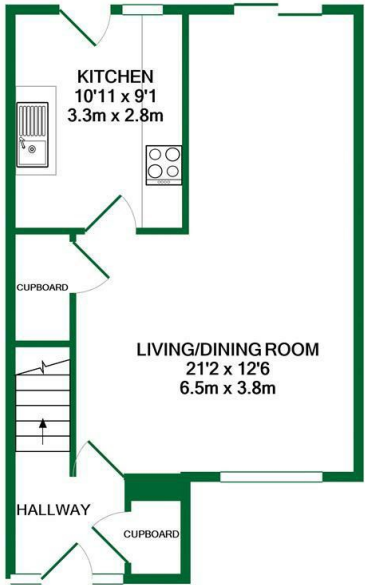

GROUND FLOOR

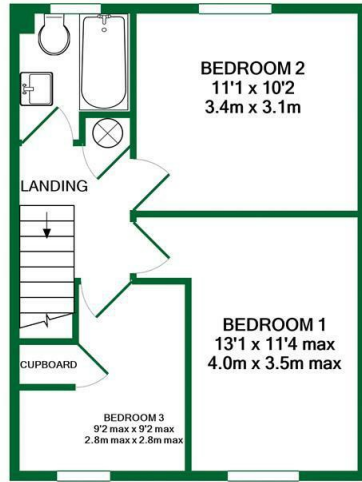

1ST FLOOR



ACCOMMODATION

- THREE BEDROOM MID TERRACE
- TRAFFIC FREE LOCATION
- GARAGE IN BLOCK
- NEWLY REFURBISHED FULLY TILED BATHROOM
- PARKING
- PRIVATE GARDEN
- EPC - D



TOTAL APPROX. FLOOR AREA 840 SQ.FT. (78.0 SQ.M.)
 Whilst every attempt has been made to ensure the accuracy of the floor plan contained here, measurements of doors, windows, rooms and any other items are approximate and no responsibility is taken for any error, omission, or mis-statement. This plan is for illustrative purposes only and should be used as such by any prospective purchaser. The services, systems and appliances shown have not been tested and no guarantee as to their operability or efficiency can be given
 Made with Metropix ©2020

The Old Butchers, 15 High Street, Twyford, Berkshire, RG10 9AB
 t: 0118 934 0027 e: twyford@wentworthea.com

IMPORTANT: we would like to inform prospective purchasers that these sales particulars have been prepared as a general guide only. A detailed survey has not been carried out, nor the services, appliances and fittings tested. Room sizes should not be relied upon for furnishing purposes and are approximate. If floor plans are included, they are for guidance only and illustration purposes only and may not be to scale. If there are any important matters likely to affect your decision to buy, please contact us before viewing the property.



wentworth_ea



wentworthestateagents